



Course measured following shortest possible route. Course is to-scale.



# Cornerstone Park 5K

Englewood, CO  
 USA TF Certificate CO13011DCR  
 Effective 4/15/2013 - 12/31/2023

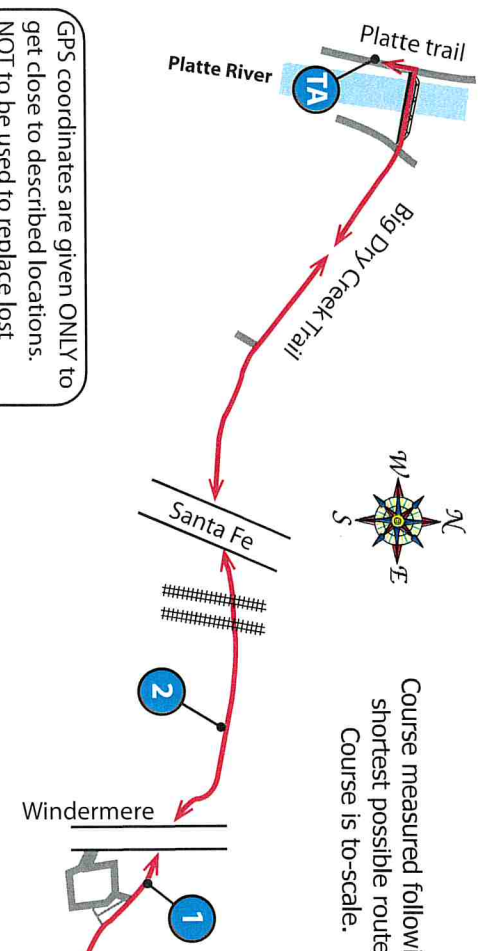

GPS coordinates are given ONLY to get close to described locations. NOT to be used to replace lost marks. Use descriptions to replace lost marks: NAD83

Start/Fin: N39.62084 W105.00128  
 1 mile: N39.62847 W105.00615  
 TA: N39.63062 W105.01504  
 2 mile: N39.62918 W105.00777  
 3 mile: N39.62151 W104.99986

*RaceMeasure* has measured this course following USATF guidelines, and stands by the measurement. However, *RaceMeasure* does not set out the course on race-day, and is not responsible for course not set out precisely according to this map.

Locations marked with yellow paint and a nail/washer.  
 Start/Finish: Inline with the 1st power pole W of Greenwood  
 1 mile: 25' W of "Big Dry Creek trailhead" sign  
 TA: 121' S of S edge of red brick pattern  
 2 mile: 75' W of eastbound "Curve" sign, W of Windermere  
 3 mile: 25' S of sidewalk into apartments

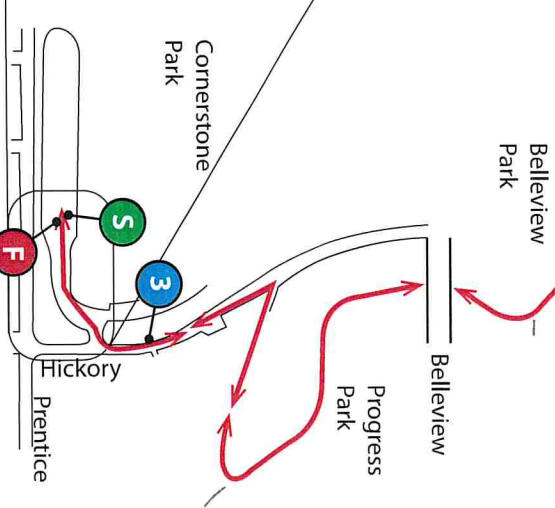
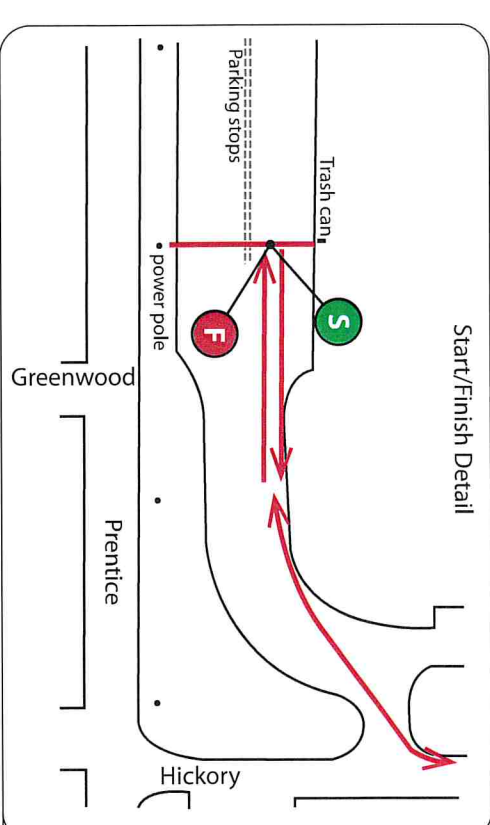

Start/Finish elevation: 5,410' High point: 5,410' Low point: 5,302'  
 Measurement, map, and elevation profile by RaceMeasure, April 2013. www.RaceMeasure.com

1

2

3

[RaceMeasure Home](#)

**Jeremy Bitner Memorial 5k & 10k**

Englewood, CO

5k USATF Certification # CO13011DCR

10k USATF Certification # CO13012DCR

[Race Website](#)

[5k Printable map](#)   [5k Non-certified MapMyRun map](#)   [5k GPS \(gpx\) file](#)   [5k Important photos](#)

[10k Printable map](#)   [10k Non-certified MapMyRun map](#)   [10k GPS \(gpx\) file](#)   [10k Important photos](#)

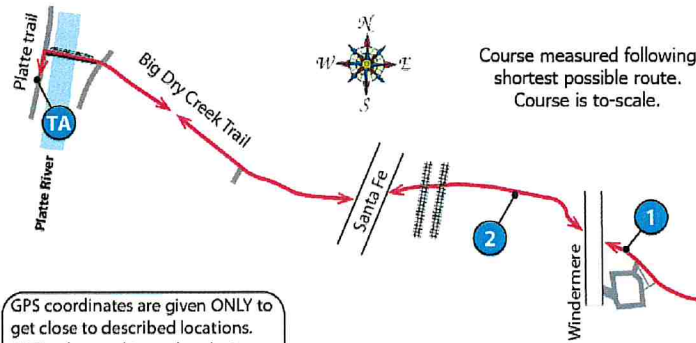

**Cornerstone Park 5k**

Englewood, CO  
 USATF Certificate CO13011DCR  
 Effective 4/15/2013 - 12/31/2013

Locations marked with yellow paint and a nail/washer:  
 Start/Finish: Inline with the 1st power pole W of Greenwood  
 1 mile: 25' W of "Big Dry Creek trailhead" sign  
 TA: 121' S of S edge of red brick pattern  
 2 mile: 75' W of eastbound "Curve" sign, W of Windermere  
 3 mile: 25' S of sidewalk into apartments

GPS coordinates are given ONLY to get close to described locations. NOT to be used to replace lost marks. Use descriptions to replace lost marks. NAD83

Start/Fin: N39.62084 W105.00128  
 1 mile: N39.62847 W105.00615  
 TA: N39.63062 W105.01504  
 2 mile: N39.62918 W105.00777  
 3 mile: N39.62151 W104.99986

*RaceMeasure* has measured this course following USATF guidelines, and stands by the measurement. However, *RaceMeasure* does not set out the course on race-day, and is not responsible for course not set out precisely according to this map.

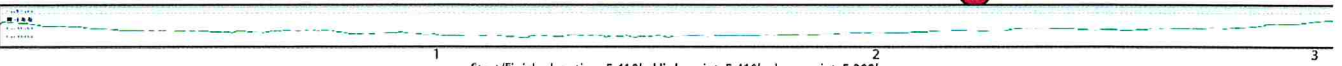
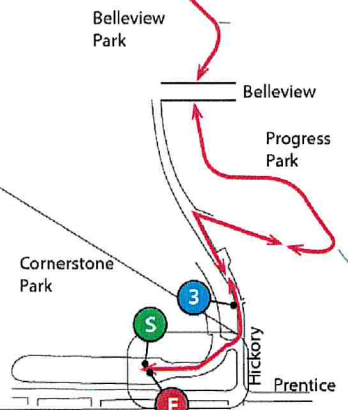
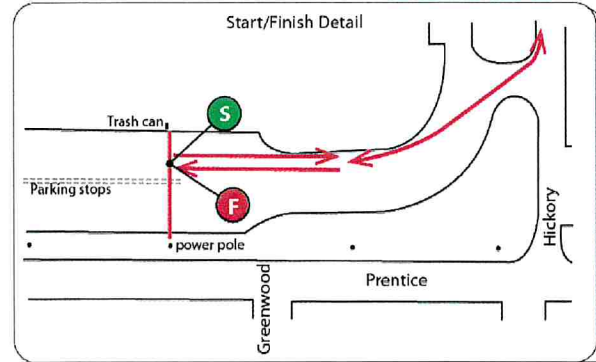

Start/Finish elevation: 5,410' High point: 5,410' Low point: 5,302'  
 Measurement, map, and elevation profile by RaceMeasure, April 2013. [www.RaceMeasure.com](http://www.RaceMeasure.com)

10k map:



# Cornerstone Park 10K

Englewood, CO  
 USATF Certificate CO13012DCR  
 Effective 4/15/2013 - 12/31/2023



Course measured following  
 shortest possible route.  
 Course is to-scale,

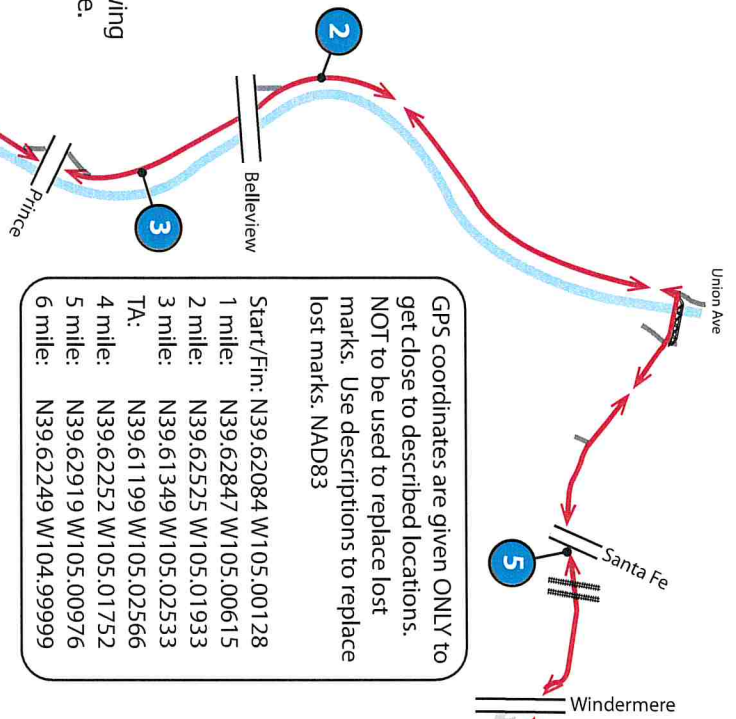

GPS coordinates are given ONLY to get close to described locations. NOT to be used to replace lost marks. Use descriptions to replace lost marks. NAD83

|            |           |            |
|------------|-----------|------------|
| Start/Fin: | N39.62084 | W105.00128 |
| 1 mile:    | N39.62847 | W105.00615 |
| 2 mile:    | N39.62525 | W105.01933 |
| 3 mile:    | N39.61349 | W105.02533 |
| TA:        | N39.61199 | W105.02566 |
| 4 mile:    | N39.62252 | W105.01752 |
| 5 mile:    | N39.62919 | W105.00976 |
| 6 mile:    | N39.62249 | W104.99999 |

Locations marked with yellow paint.

- Start/Finish: At first power pole W of Greenwood
- 1 mile: 25' W of "Big Dry Creek trailhead" sign
- 2 mile: 8' N of concrete pad on W side of trail
- 3 mile: 1' S of "Centennial Grill" sign to tennis complex
- TA: 81' S of concrete pad to cinder trail
- 4 mile: 90' N of "Speed Limit 15" sign
- 5 mile: 24' E of E edge of Santa Fe bridge
- 6 mile: 122' E of gate in fence by Hickory

RaceMeasure has measured this course following USATF guidelines, and stands by the measurement.  
 However, RaceMeasure does not set out the course on race-day, and is not responsible for course not set out precisely according to this map.

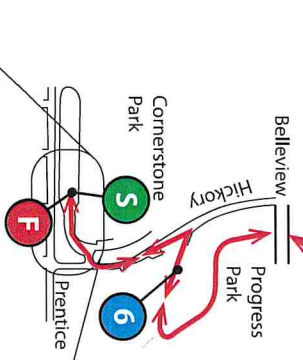

Start/Finish Detail

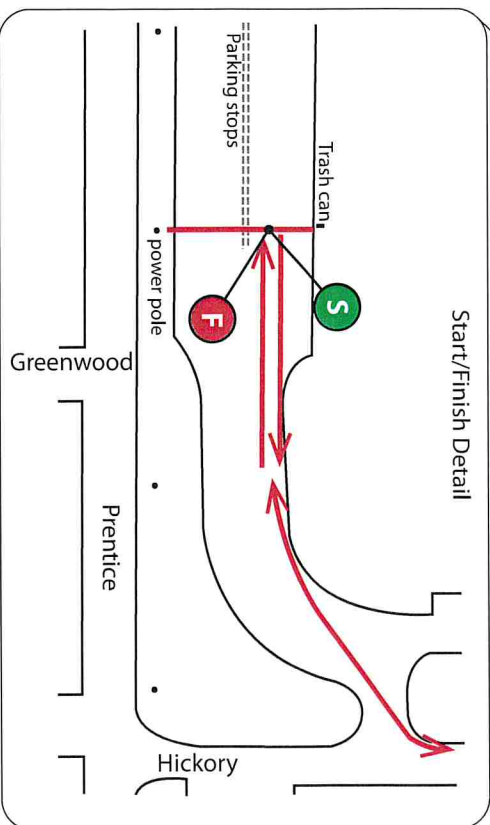

1 2 3 4 5 6

Start/Finish elevation: 5,410' High point: 5,410' Low point: 5,302'  
 Measurement, map, and elevation profile by RaceMeasure, April 2013. www.RaceMeasure.com



# Cornerstone Park 10

Englewood  
 USATF Certificate CO1301.  
 Effective 4/15/2013 - 12/31/

